



Mark 50 Bagger



We are s/l/i/c/e/d bread!

SPECIFICATIONS:

Maximum Loaf Size:

Length 16" (406 mm), width 5 1/2" (140 mm), height 6" (152 mm)

Electrical Requirements:

230/460 volts, 60 Hz, 3-phase AC 15 am service for 2hp drive motor.

Closer unit requirements are additional depending upon the unit.

Other voltages available on request.

Rated speed:

Variable up to 60 loaves per minute.

Air requirements:

12 CFM (340 cm) of free air at 80 PSI (5.625 kg/cm).

Weight (Approximate):

1650 lbs. net (750 kg), 1850 lbs. shipping (840 kg), 2650 lbs. export (1205 kg)

STANDARD FEATURES:

2hp motor

Plant voltage with DC control voltage

NEMA 4 enclosures with sealtite conduit

Control box with all new electricals

Nexen clutch/brake or thru VFD

Conveyor dead plates are spring loaded

5' 11" infeed conveyor and drive

Shuttle assembly w/composite bushings

Roller blockade assembly w/hyvee rollers

Stainless steel lever arm

Double wicket holder

Aluminum guarding

Helical bevel gear box 27:1

All new bearings, sprockets, chains, and shafts

ACCESSORIES:

Additional conveyor lengths available

Stainless steel guarding

6' extended discharge

Extra set of scoops

Automatic double wicket

Tubular Framing

Stainless steel framing

Phase change

Remote scoop adjuster

AB PLC/HMI

Control Techniques drive

Upper and lower scoops included

New drive cam for smoother product delivery

Bag tensioner device

Technical Layout:

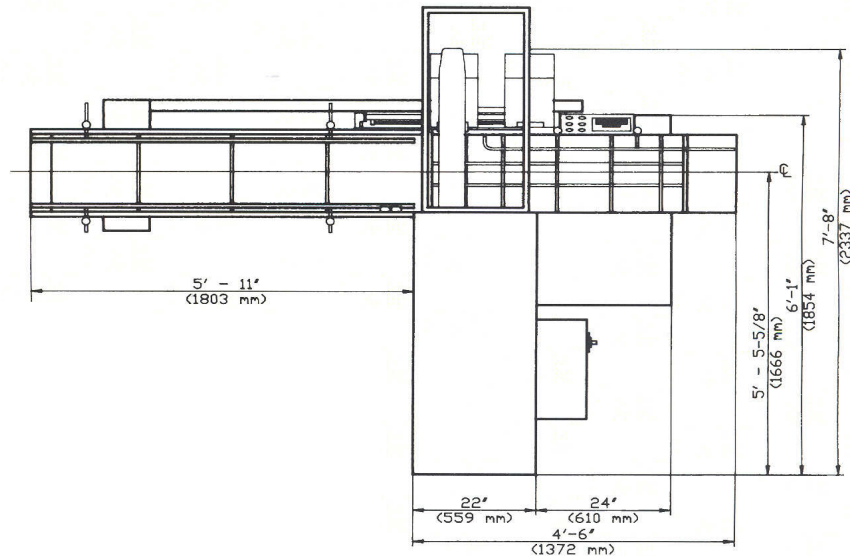

Bettendorf Stanford, Inc.

P.O. Box 790, Salem, IL 62881

E-mail: sales@bettendorfstanford.com

Phone: (800) 548-2253

Fax: (618) 548-3557

Website: www.bettendorfstanford.com